

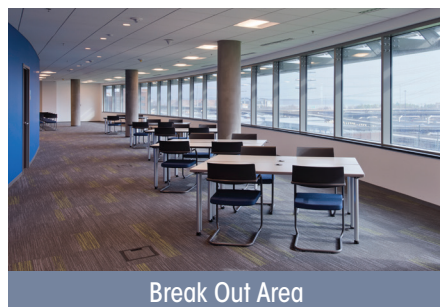

Educational Area



Break Out Area



Warming Kitchen



East Terrace

## The Educational Area and Breakout Area: Large, flexible, meeting-friendly.

With their open space layouts and beautiful views, the Educational Area and Breakout Area of Alexandria Renew's Environmental Center offer a unique and memorable meeting experience. The 1,655 square-foot Educational Area and 1,195 square-foot Break out Area can be reserved together or separately.

Features include:

- A/V projector and screen
- Free Wi-Fi
- Warming kitchen: sink, coffee maker, dishwasher, ample counter serving space, two refrigerators with freezers, two warmers, an ice maker, and room for an additional serving table
- Access to outdoor terrace with spectacular views
- Dry-erase feature walls
- Tables and chairs: note – larger groups or varying setups may require rental of tables, chairs and linens
- Adult beverages: must obtain own permit and bring own beverages
- Easily accessible via King Street or Eisenhower Metro stations

To request a room, visit  
[www.alexrenew.com/requestroom](http://www.alexrenew.com/requestroom).  
 For more information, call **(703) 549-3381**  
 and ask for the events coordinator.

1800 Limerick Street, Alexandria, VA 22314



## Educational Area and Break out Area

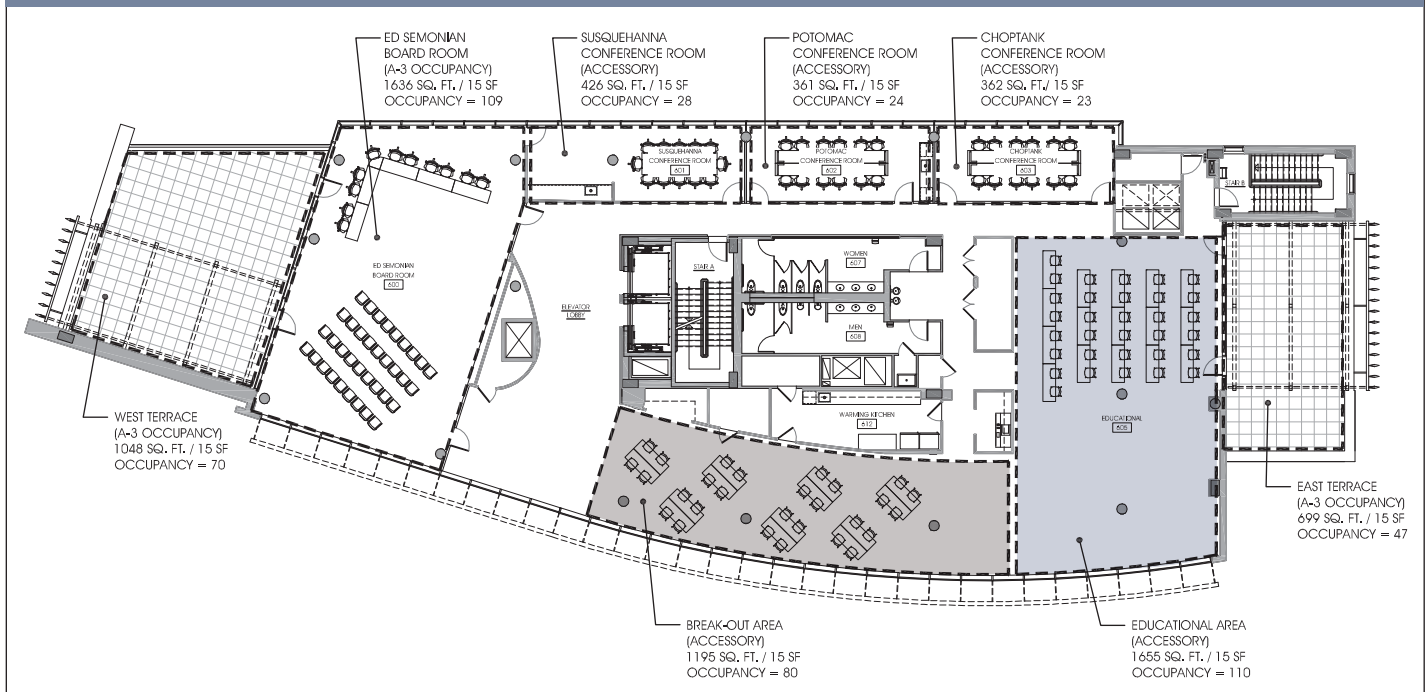

### Educational Area

U-Shape

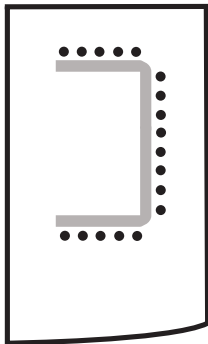

Theatre

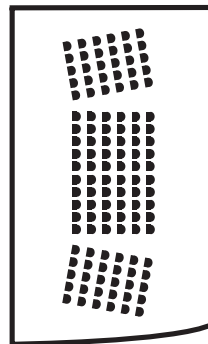

Class Room

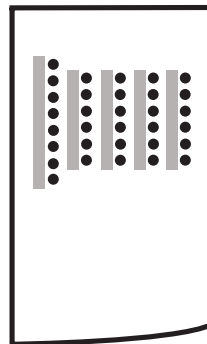

Banquet

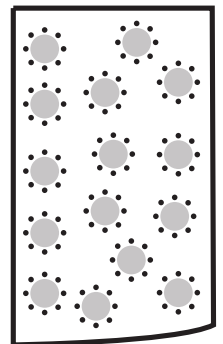

Break out Area - Table Seating

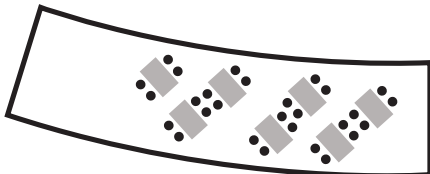

Break out Area - High Tops

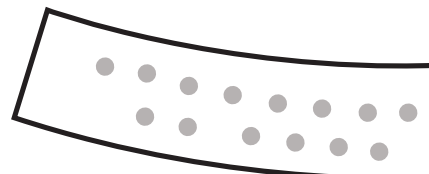

Name	Square Feet	Board Room	U-Shape	Theatre	Classroom	Banquet	Special Features
Educational Area w/ Break out Area	2,850	22	18	110	32	184	A/V, Wi-Fi, Dry Erase Walls

To request a room, visit [www.alexrenew.com/requestroom](http://www.alexrenew.com/requestroom).

For more information, call (703) 549-3381 and ask for the events coordinator.

1800 Limerick Street, Alexandria, VA 22314